

REGENERATIVO EKZ 103 - 36

Modelo: EKZ 103 - 36 **Presión Máx:** 250 (mbar) / 3.6 (psig)
Fases: Tres **Vacío Máx:** - 250 (mbar) / 7.4 (inHg)
Motor: 0.83 (kw) **Peso:** 14 (kg)
Ruido: 61 dB (A) **Flujo:** 103 (m³/h)
Frecuencia: 60 (Hz) **Etapas:** Dos
Amperaje: 3.75 / 2.15 (Amps)
Voltaje: 208 - 220 V / 440 - 460 V
Conexiones: 1 - 1/4" NPT

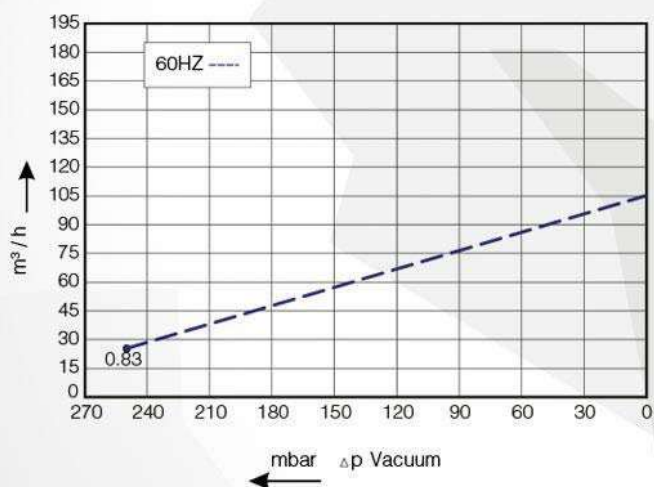

Vacío



Presión

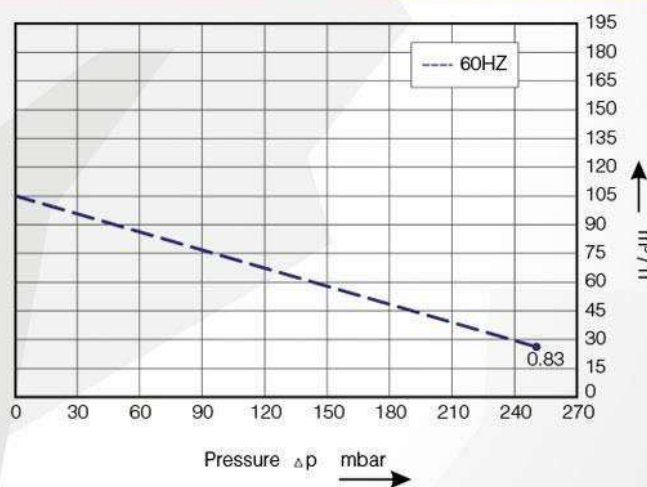

Dimensiones

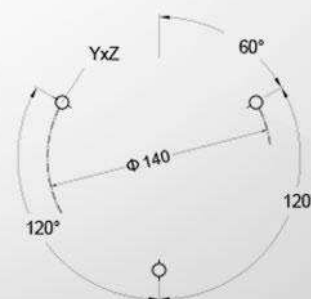
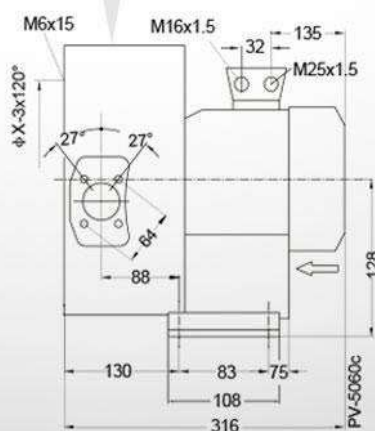
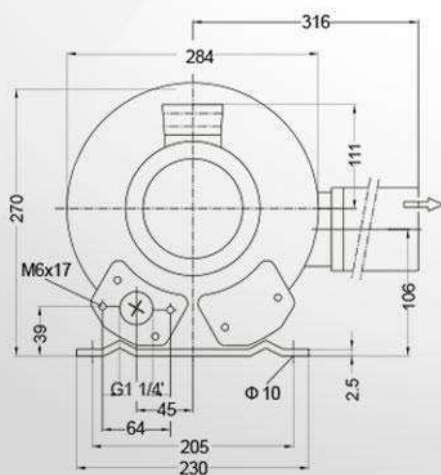

Unidad: mm